

NEW DELHI

816, Laxmi Deep,
Laxmi Nagar, New Delhi
Mob: +91- 9762725249
Email: enquiry.arko@gmail.com

GHAZIABAD

M/S. ARK099 PLASTIC AND STEELS
Cm-31c, 1st Floor
Gagan Enclave
Gt Road ,Ghaziabad
U.P. 201001
0120-2866969

KOLKATA

M/S. BUILDCON
137 E, Picnic Garden Road,
Ground Floor, Kolkata ,West Bengal- 700039
Mob - 8240284302
Email - wbsales.arko@gmail.com

GUWAHATI

M/S. LP ASSOCIATES
Nar-narayan Road
West Durgasrobar
Kamakhya Gate, Guwahati
781009, Assam
Mob - 9864062866
Email -sushil.lpa@gmail.com

GWALIOR

Bindal Plywood, Behind
Old Police Chowky, Daulatganj
Lashkar, Gwalior
M.P.- 474001
Mob -9762725249

ARKO BUILDING PRODUCTS PVT. LTD.

www.arkobuildingproducts.com

AN ISO
9001:2015
CERTIFIED

ROOFING



WE DON'T
JUST SUPPLY
WE BUILD



FLOOR DECK

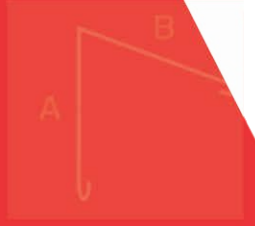
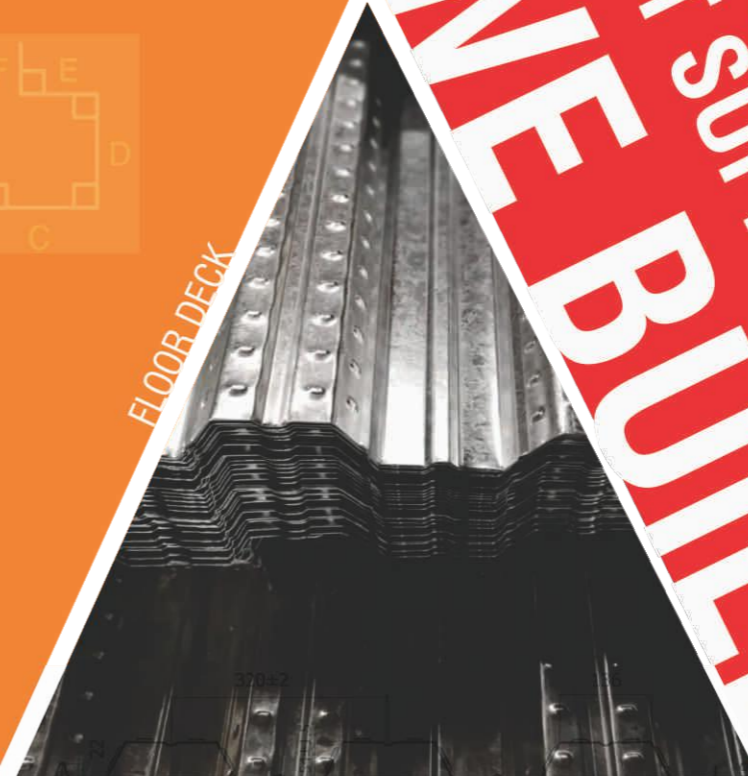

PURLIN & SECTIONS

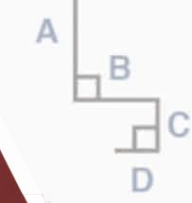
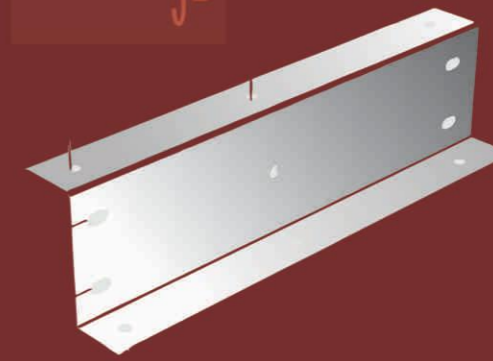

AIR TURBO VENTILATOR



ABOUT US

Arko Product Portfolio are Roofing Sheets, Puf Sandwich Panels, Galvalume & Galvanized Color Coated SMP/RMP Sheets, Decking Sheets, Polycarbonate Sheets, Skylight Polycarbonate Multiwall, Self Drilling Screws, Purlins, PEB building.

24/7 Emergency Available



Satisfaction Guarantee



Expert and Professional



Free Inspection



OUR PRODUCTS & SERVICES

- ARKO commenced its operations in 2014, and pioneered the high-end metal roofing products market in India.
- Arko has been the first mover in India, who gives service after sales. We are not just supplying we deliver the projects.
- We are also involved in installation service for all over INDIA and foreign.
- We have launched our new product UPVC Roofing Sheet and Turbo Ventilator fans as well.



ROOF REPLACEMENT/ ROOFING SHEETS



PRE FABRICATED ROOMS

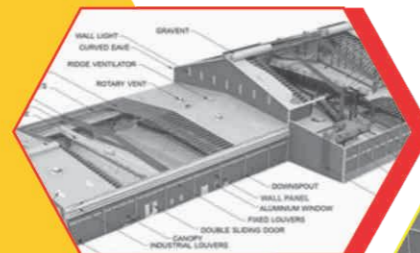

PRE FABRICATED BUILDINGS

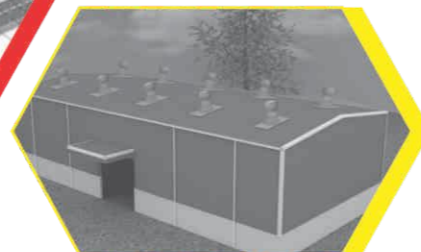

ROOFING & CLADDING SYSTEMS



POLYCARBONATE/ MULTIWALL



PRE-ENGINEERED BUILDING

ROOFING | arko TECH

HI RIB

ROOF & CLADDING SYSTEMS

ARKO MAKE colour metal roofing is the most versatile roofing product in the market and offers you both elegance and flexible design for any building need.

Long lengths and weatherproof side lap allow ARKO TECH to be used safely on roof pitches as low as 3 deg in single sheet lengths, 5 deg with end laps, and for vertical cladding. ARKO Hi-Rib is also available in crimp curved sections.



Pre-Painted GalvaZinc (Galvalume)

(55% Aluminium 44% Zinc Alloy 1.3% Silicon)

GalvaZinc Coating: AZ 150 GSM

Primer service coat: 5 microns epoxy / PU on both sides

Paint Coat : Regular Modified Polyester
Silicon Modified Polyester & PVF 2

Paint Thick (top): 18-20 microns

Paint Thick (bottom): 5-7 microns

Surface paint reflection: Semi Gloss / Matt finish

Conforms to : ASTM A792, A755, JIS G3321, G3322, AS 1397

Yield Strength) : 550 Mpa

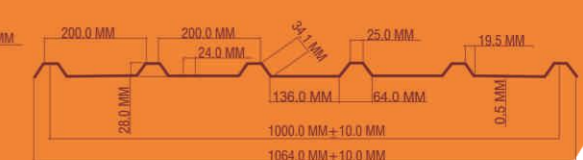

Pre-Painted Galvanized (Galvanized)

(120 GSM Galvanized Steel Sheet)

GalvaZinc Coating : Z 120 GSM

Primer service coat : 5 microns epoxy / PU on both sides

Paint Coat : Regular Modified Polyester
Silicon Modified Polyester & PVF 2

Paint Thick (top) : 18-20 microns

Paint Thick (bottom) : 5-7 microns

Surface paint reflection : Semi Gloss / Matt finish

Conforms to : IS:277, IS:14246

Yield Strength) : 245/550 MPA

COLOR COATED SHEET COATING PROCESS

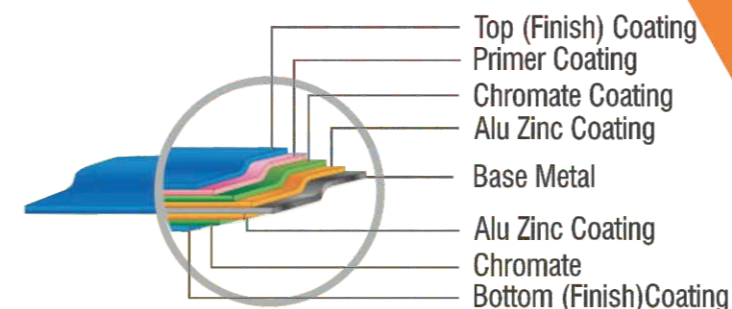

Top (Finish) Coating
Primer Coating
Chromate Coating
Alu Zinc Coating

Base Metal

Alu Zinc Coating

Chromate

Bottom (Finish)Coating

TABLE 1

Max. allowable support spacings

Type of Span	0.50 mm TCT steel (550 Mpa)	0.50 mm TCT steel (240 Mpa)
Roofs		
Single	900 mm	800 mm
Internal span	1800 mm	1400 mm
End span	1200 mm	1000 mm
Overhangs		
Without edge stiffening	150mm	150mm
With edge stiffening	300mm	300mm
Walls		
Single span	1500 mm	1100 mm
Internal span	2000 mm	1400 mm
End span	1800 mm	1200 mm
Overhangs	300 mm	300 mm

SkyLight POLYCARBONATE

QAP - Solid Polycarbonate / Multiwall Polycarbonate

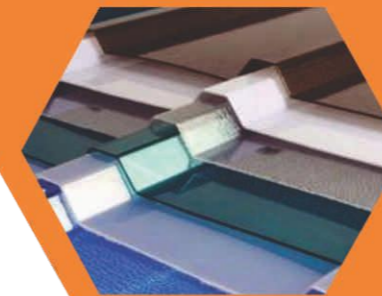
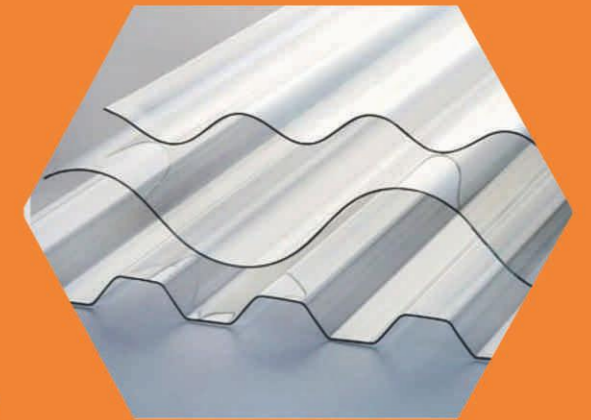

**Compact Clear /
Light Diffuser /
Embossed Polycarbonate /
Diamond**

Profile Plain or As require profile model
Material 100% Bayer/Sabic Polycarbonate Resin
Thickness 0.80mm To 12mm
Length Customizable Available
Width 4, 5, 6, 7 feet
Colour Clear, Opal White, Green,
Lake Blue, Blue, Bronze, Embossed
Accessories SDS Screws & Silicon Sealant
Protection UV Coated

Multiwall

Profile Plain twin wall/X-PROFILE
Material 100% Bayer/Sabic Polycarbonate Resin
Thickness 4 mm To 22mm
Length 39 feet & Customizable Available
Width Width - 4, 7 feet
Colour Clear, Opal White, Green,
Lake Blue, Blue, Bronze
Accessories Aluminium Channel With Gasket
and SDS Screws & Silicon Sealant
Protection UV Coated

Multicell Panel

Product Multicell Panel
Profile Interlock Panel and 100% leak proof
Material 100% Bayer/Sabic Polycarbonate Resin
Thickness 12 To 22mm
Protection UV Coated
Scratch Protection Guard Film
Length Customizable Available
Width 900mm
Colour Clear, ICE, Green, Blue, Bronze
Accessories Aluminium Channel, U & C Section,
and SDS Screws & Silicon Sealant

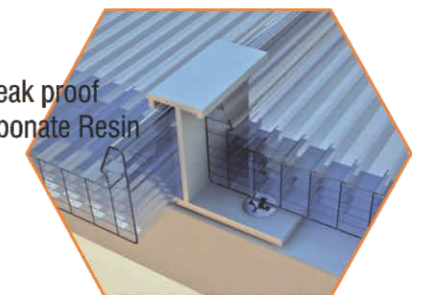

Features

- ▶ Upto 70% energy saving Arko SkyLight.
- ▶ Excellent light transmission up to 88 % (10 mm).
- ▶ UV protection: Co-Extruded 1 Side & 2 Sides.
- ▶ 10 Year Warranty Limited.
- ▶ Temperature resistant: between -40°C +130°C.

uPVC

ROOFING & CLADDING SYSTEMS

ARKO TECH UPVC is a modern rigid three layer Un-plasticized poly vinyl chloride roofing sheets. The advanced technology of manufacturing ensures superior quality and performance of the roofing product. This uPVC is the best replacement to asbestos, metal G.I. sheets, fibreglass sheets, Metal roof sheet and uPVC sheets considering the heat insulation, sound insulation, water resistance, chemical and alkali resistance, corrosion proof, fire retardant, eco friendly, easy to install and move, light weight as well as cost effective in installation and it can save construction cost up to 60%.

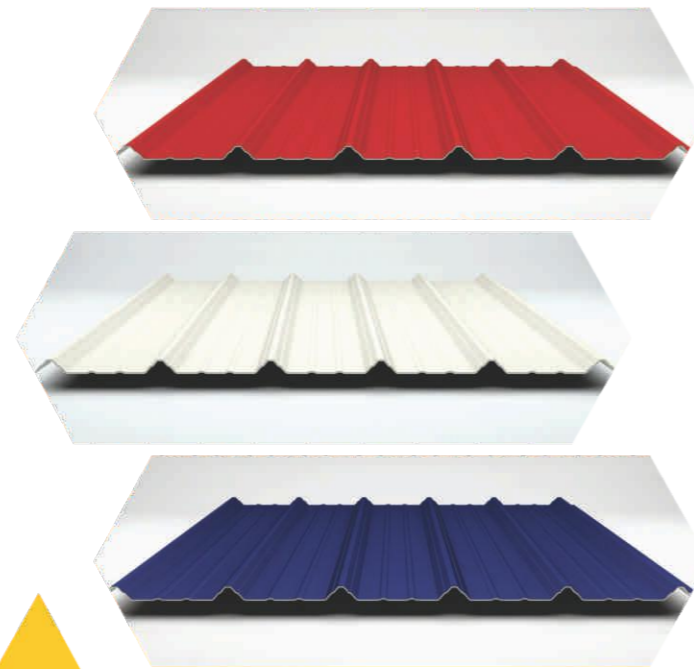

Product Sizing

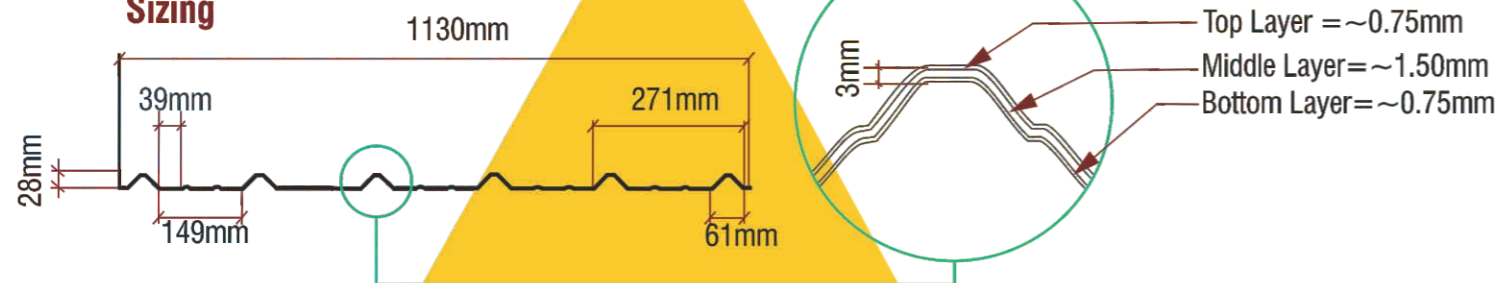

NOTE:

Length Can Be Customizable Upto
12 Mtr (Subject To Transportation)
Weight 3.4 kg Per SQM for 2 mm thickness,
4 kg per SQM for 2.5 mm thickness,
5 kg per SQM for 3 mm Thickness

Property Test Method Value

Property	Test Method	Value	Property	Test Method	Value
Density	ASTM D 792	1.47 gm/cc	Tensile Strength at break	TASTM D 638	410 Kg/cm'
Softening temp. at 10 N	ASTM D 1525	90.6 °c	Elongation at break	ASTM D 638	32%
HDT 66 PSI	ASTM D 648	71.9 °c	Oxygen index	ASTM D 2863	38%
HDT 264 PSI		66.2 °c	Flammability	UI 94	Match with Vo
Rate of Burning	ASTM D 648	<5 mm	Water Absorption	ASTM D 570	0.07%

DECK SHEETS

Composite Floor Deck is a steel deck with a ribbed profile, which binds with concrete slab and together forms a part of the floor structure. This interlocking between the concrete and the floor deck is brought about through a system of embossment and ribs which are built into the deck, creating a reinforced concrete slab that serves the dual purpose of permanent form and

positive reinforcement. Composite decking is one of the most effective method of constructing floors in steel building and very useful in high rise RCC / Steel Buildings. Metal decking can be effectively used in Multi-storey buildings Industrial / Residential), Shopping malls, Super markets, SEZs, Silos, Storage facilities, mezzanines, bridges, walkways, platforms, etc.

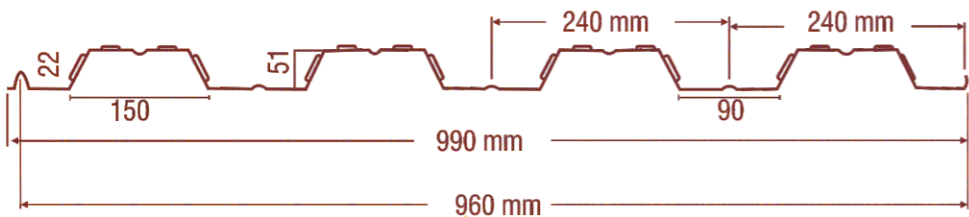

METAL DECKING

TECHNICAL SPECIFICATION

- Profiles** 44 / 130 (44 mm depth x960 mm width)
51 / 240 (51 mm depth x 990 mm width)
- Material** CR Steel as per IS:513 D-Quality /
HR Steel as per IS:1079 /
Galvanized Steel (as per IS:277)
- Thickness** 0.70 to 1.25 mm
- Length** 12000 mm (12 MTR)
- Quality** HR Steel as per IS:1079 \
Galvanized Steel (as per IS:277)
- Type** Bare, Primer coated, Galvanized
in 44/130 and 51/240 profile with
thickness range of 0.70mm to 1.25mm

We supply suitable size of decking
with optional feature as per customer's specifications / drawings,
for easy erection and also to avoid any wastage / rework at site.

Allowable Loads in kg/m2 for 245 Mpa Yield Strength of Material *

No	Thickness (mm)	SPAN IN METERS								
		1.0	1.25	1.5	1.75	2.0	2.25	2.5	2.75	3.0
1	0.70	2304	1475	1024	752	576	455	NA**	NA**	NA**
2	0.80	2633	1685	1170	860	658	520	NA**	NA**	NA**
3	1.00	3277	2097	1456	1070	819	647	524	NA**	NA**
4	1.25	4100	2624	1822	1339	1025	810	65	452	456

PURLIN & SECTIONS

Z and C purlins are specially designed to provide economy to building construction and keep the site clean and environmental friendly and it is a strong and sturdy to hold the building in position for lifelong. Z and C section are accurately roll formed from high strength galvanised steel, Arko give cut to the length section with pre punched hole as per your drawing and required dimensions to provide speed and faster construction.

- Up to 40-50% weight saving of structural steel and cost up to 25-30% (As compared to hot rolled) Up to 30-40% weight saving and 15% cost (As compared to tubular purlins)
- Highly cost effective
- Purlins are crisp, clean and square.
- No rounded corners, inaccurate lengths or out of square purlins any more.
- Easy to install and light in weight
- Excellent corrosion resistance, durability and long Life

Typical Connection

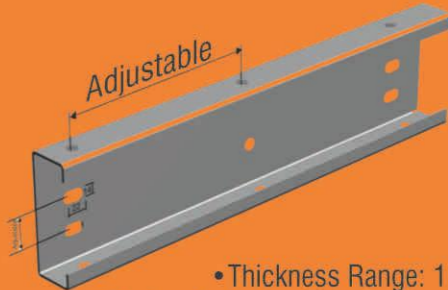
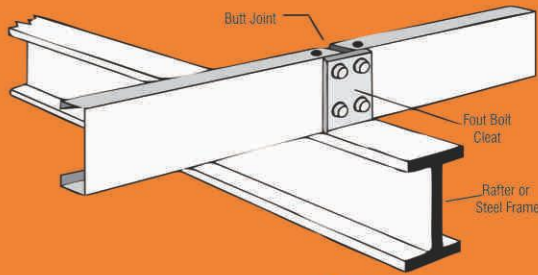

- Thickness Range: 1 to 3mm
- Customized size of purlin also available

Purlin-C		ARKOTECH Purlin 'C' Shape			
SIZE	A	a	C		
C100	100	50	15		
C160	160	60	15		
C180	180	60	18		
C200	200	70	20		
C220	220	80	20		
C250	250	70	20		
C300	300	80	20		

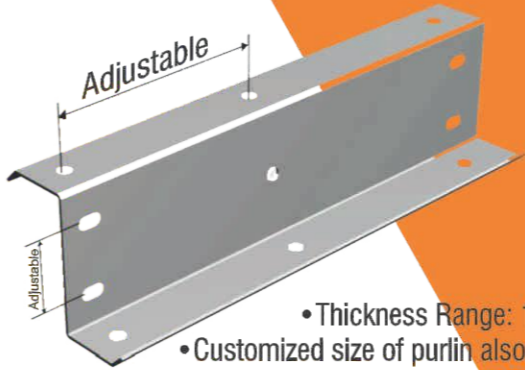

- Thickness Range: 1 to 3mm
- Customized size of purlin also available

Purlin-Z		ARKOTECH Purlin 'Z' Shape			
SIZE	A	B	C		
Z100	100	50	15		
Z160	160	60	15		
Z180	180	60	18		
Z200	200	70	20		
Z220	220	80	20		
Z250	250	70	20		
Z300	300	80	20		

Typical Connection

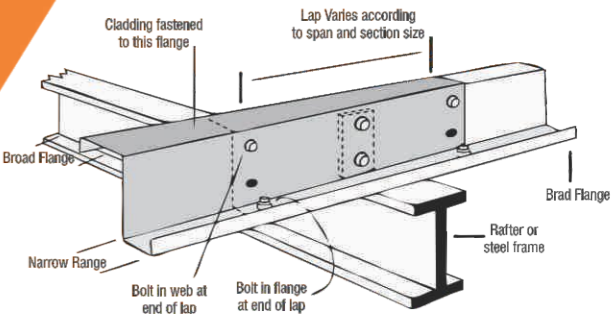

PP - S.S. TURBO

ARKO PP - S.S. Turbo Ventilators are manufactured using a combination of Stainless Steel(S.S.) and Polypropylene (PP), which is a Thermoplastic.

The Top Cover and the Fins of the Fans are fabricated using Stainless Steel (S.S.), while the Bottom Ring along with all the Internal Fittings (except the Internal Shaft) are in 100% virgin Polypropylene (PP).

They are available in an Internal Throat Diameter of 24" (610 MM) and have a total of 39 nos. of Fins, each in Stainless Steel (S.S.).

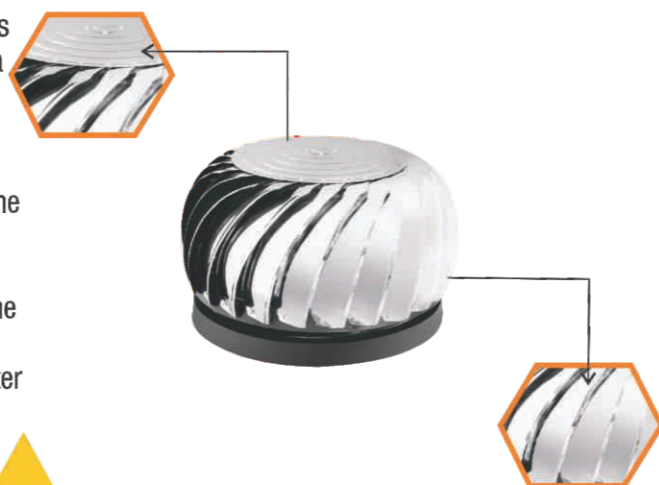

MATERIAL OF CONSTRUCTION (M.O.C.)

SIZE (THROAT DIA)	MODEL	NO. OF FINS	FINS	TOP COVER	BOTTOM RING	FASTENERS	INTERNAL FITTINGS	BEARINGS
560 MM	PPSS 22	24	0.35 MM S.S. 430	0.50 MM S.S. 430	Polypropylene (PP)	G.I.	Shaft- G.I. Other Fittings - PP	HCH make or equivalent

MATERIAL OF CONSTRUCTION (M.O.C.)

SIZE (THROAT DIA)	MODEL	NO. OF FINS	FINS	TOP COVER	BOTTOM RING	FASTENERS	INTERNAL FITTINGS	BEARINGS
610	PPSS 24	39	0.35 MM S.S. 430	0.50 MM S.S. 430	Polypropylene	G.I.	Shaft G.I. Other PP	HCH make or equivalent

- **Exhaust Capacity (in C.F.M.):** 2700
- **Throat (Neck) Dia I Belly (Centre) Dia:** 22" (560 MM) I 24 " (610 MM)
- **Height:** 15" (380 MM) (across all Models)
- **Shaft Dia-** 15.00 MM (across all Models)
- **Bearing Type-** Double Jet Sealed Boll Bearings: 6201-2RS & 6202-2RS
- **Internal Fittings (except Shaft):** Polypropylene (PP)
- **Stainless Steel Make-** Jindal or equivalent
- **Packing:** 3 / 5 Ply Corrugated Boxes The has & lop Plate of the Fans can also be painted or powder coated for extra weather protection

VENTILATOR FANS | arko TECH

ALUMINIUM TURBO

ARKO ALUMINIUM are manufactured using top quality Industria Grade Aluminium and are renowned for their quality, performance and durability in extreme weatherconditions and tough industrial environments. The Fins of the Aluminium Fans are manufactured using Aluminium, where as the Top Cover and Bottom Ring can be manufactured using Aluminium or Stainless Steel depending on the customer requirement.



MATERIAL OF CONSTRUCTION (M.O.C.)

SIZE (THROAT DIA)	MODEL	NO. OF FINS	FINS (BLADES)	TOP COVER	BOTTOM RING (NECK)	RIVETS/ FASTENERS	INTERNAL FITTINGS	BEARINGS	NET WT.
24" (600 MM)	ATV-300-L	42	0.50 MM ALL	1.20 MM AL or 0.50 MM S.S.304	1.20 MM AL .or 0.50 MM S.S.304	AL/S.S or equivalent	S.S or equivalent	SKF make or equivalent	4.40 KILOS
21" (530 MM)	ATV-300-S	36	0.50 MM ALL	1.20 MM AL or 0.50 MM S.S.304	1.20 MM AL .or 0.50 MM S.S.304	AL/S.S or equivalent	S.S or equivalent	SKF maket or equivalent	4.00 KILOS

- **Exhaust Capacity (in C.F.M.) (600 MM Dia 530 MM Dia):** 2700 / 2500
- **Throat (Neck) Dia I Belly (Centre) Dia:** 24" (600 MM) I 28" (710 MM) & 21" (530 MM) I 26" (660 MM)
- **Height:** 16" (400 MM) (across all Models)
- **Shaft Dia:** 11.80 MM (across oil Models)
- **Bearing Type:** Double Jet Sealed Ball Beanngs (6011-2RS)
- **Internal Fittings (Shaft, Bearing Covers, X Frame, Rotary Axel):** G.I. or S.S. (depending on the series)
- **Aluminium Make / Specifications:** Hindalco or equivalent / 8011 Senes (H-14 Temper)
- **Stainless Steel Make:** Jindal or equivalent

STAINLESS STEEL TURBO

ARKO Stainless Steel (S.S.) turbo ventilator fans are manufactured using top quality Stainless Steel (S.S.) and are renowned for their mechanical strength, impact resistance and performance. Their Fins are in S.S. where as the Top Cover and Bottom Ring can be made available in Stainless Steel (S.S.) or Aluminium (AL.) depending on the customer requirement.



MATERIAL OF CONSTRUCTION (M.O.C.)

SIZE (THROAT DIA)	MODEL	NO. OF FINS	FINS	TOP COVER	BOTTOM RING	RIVETS/ FASTENERS	INTERNAL FITTINGS	BEARINGS	NET WT.
600 MM (24")	ATV300L	42	0.35 MM S.S.304 /430	1.20 MM AL. or 0.50 MM S.S.304 /S.S.430	1.20 MM AL. or 0.50 MM S.S.304	AL/S.S.	S.S.	SKF make or equivalent	5.80 KILOS
530 M (21")	ATV300S	36	0.35 MM S.S.304	1.20 MM AL or 0.50 MM S.S.304 /S.S.430	1.20 MM AL. or 0.50 MM S.S.304	AL/S.S.	S.S.	SKF make or equivalent	5.00 KILOS

- **Exhaust Capacity (in C.F.M.) (600 MM Dia 1530 MM Dia):** 2700 / 2500
- **Throat (Neck) Dia I Belly (Centre) Dia:** 24" (600 MM) I 28" (710 MM) & 21" (530 MM) I 26" (660 MM)
- **Height:** 16" (400 MM) (across all Models)
- **Shaft Dia:** 11.80 MM (across oil Models)
- **Bearing Type:** Double Jet Sealed Ball Beanngs (6011-2RS)
- **Internal Fittings (Shaft, Bearing Covers, X Frame, Rotary Axel):** G.I. or S.S. (depending on the series)
- **Aluminium Make / Specifications:** Hindalco or equivalent / 8011 Senes (H-14 Temper)
- **Stainless Steel Make:** Jindal or equivalent

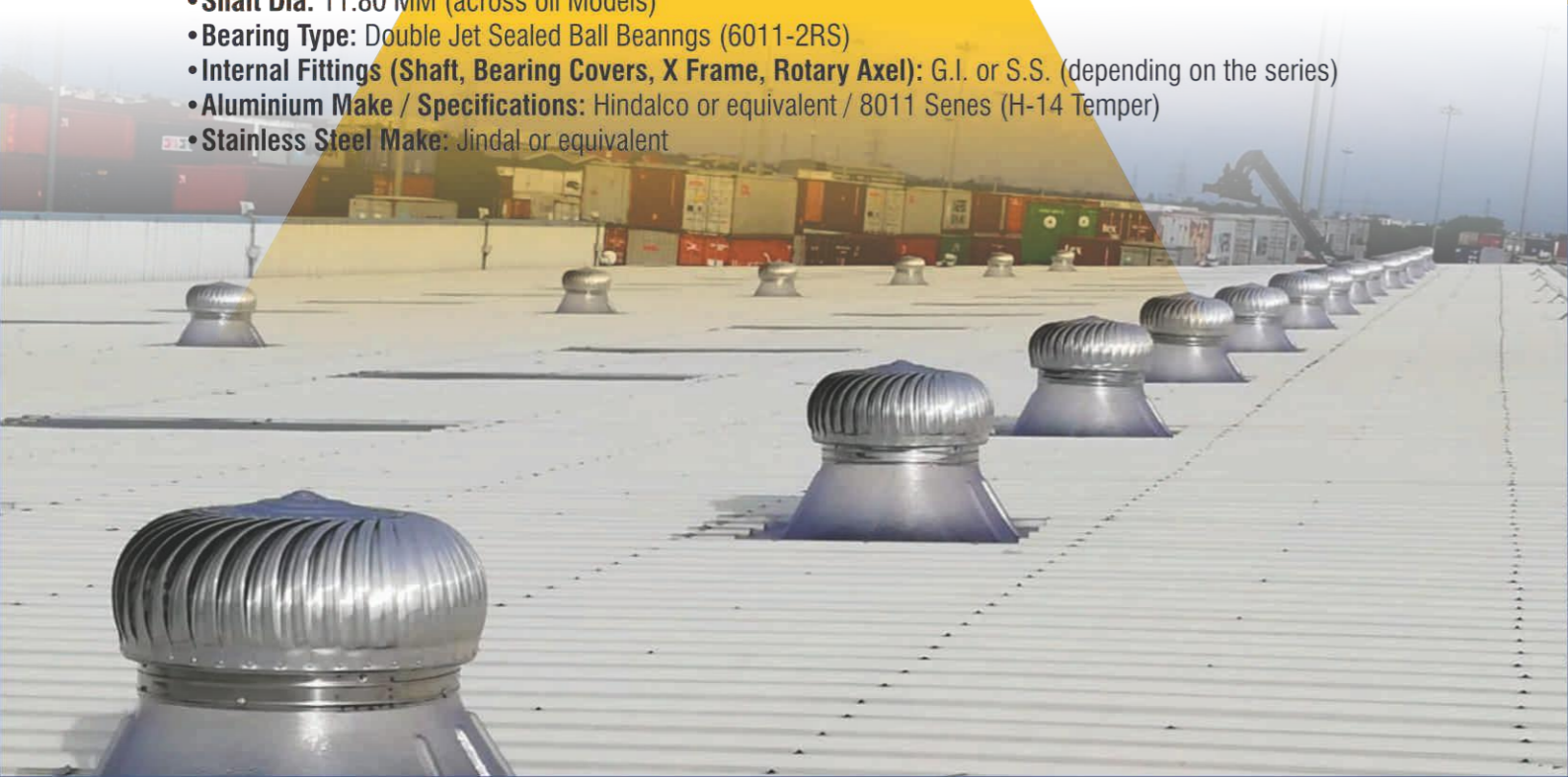

VENTILATOR FANS | arko TECH

POLYCARBONATE BASE PLATE

- They are Vacuum Formed using 100% virgin and U.V. stable PC Solid Plain Sheets.
- The PC Sheets are also provided with a 30 micron thick U.V. Coating on one or both sides (as required by the customer) to guard against harmful U.V. Rays of Sun. As a result, they do not de-generate rapidly (become yellow and brittle) when exposed to sunlight for long periods of time.
- They are highly durable and have a service life of more than 10 years.

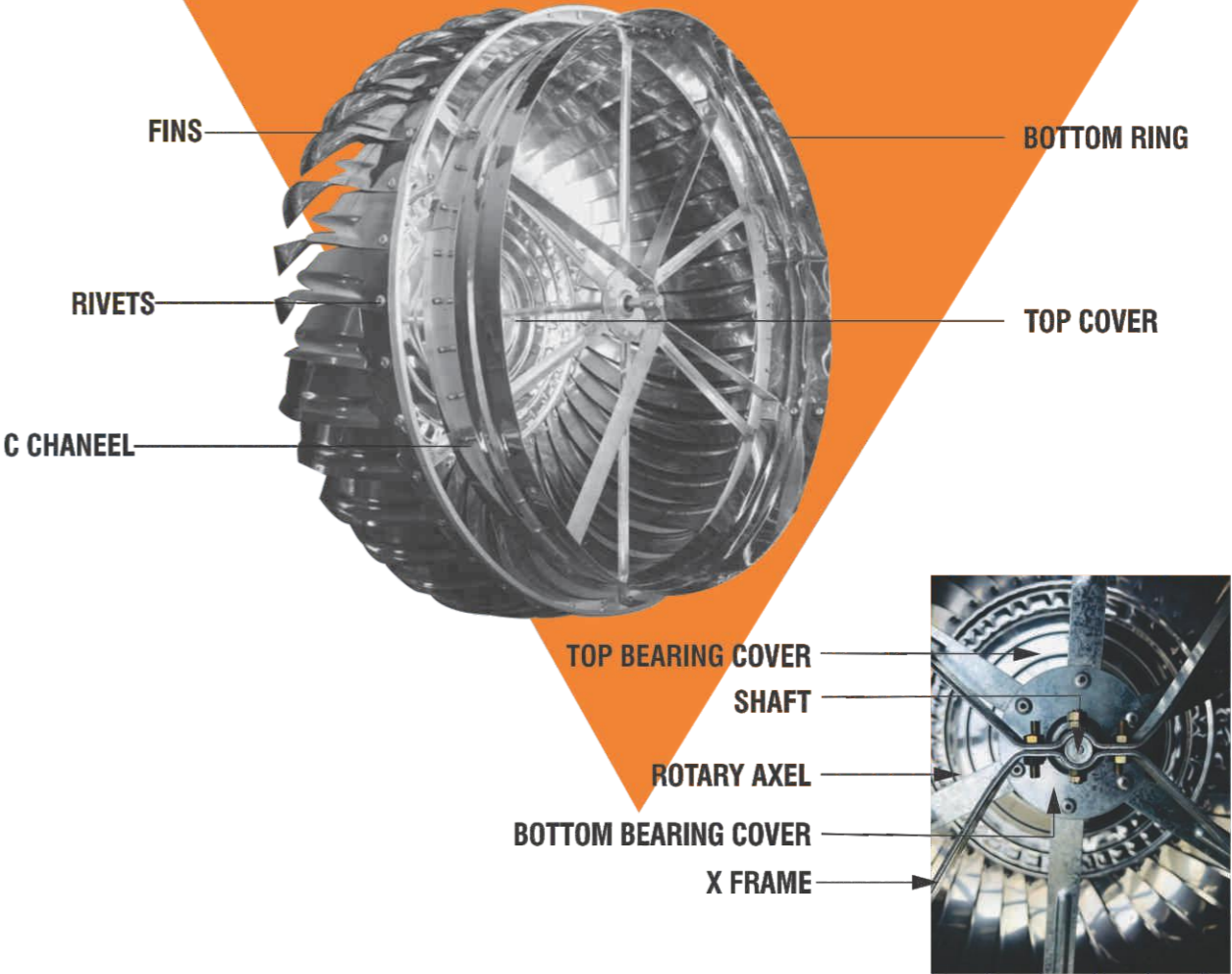
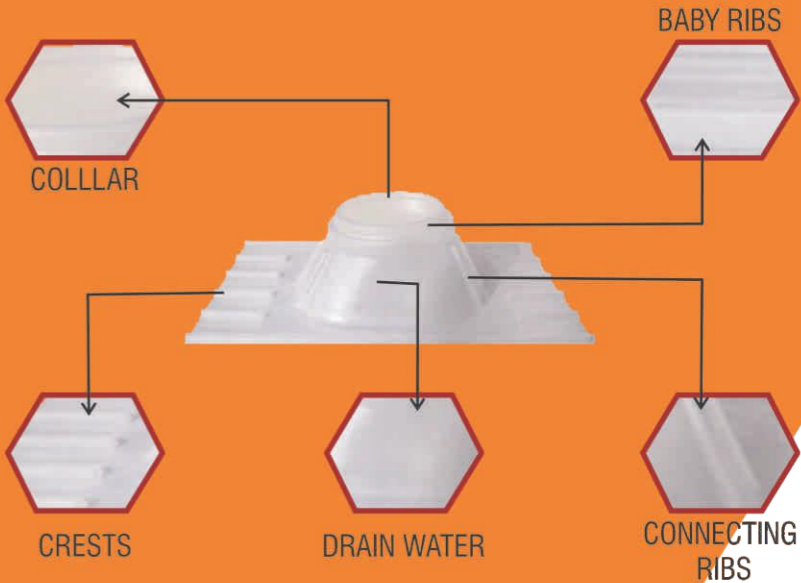

FLASHINGS AND ACCESSORIES

Arko offer a complete range of Roof flashings and Accessories. These include Ridge Cap, Barge Cap, Drip, Eaves, Gutters, Turbo Ventilator, Self Drilling Screw, Silicone Sealant, Butyl Tape. It is important that these are versatile and practical, but perhaps the ability to enhance the appearance of any building is of prime concern.

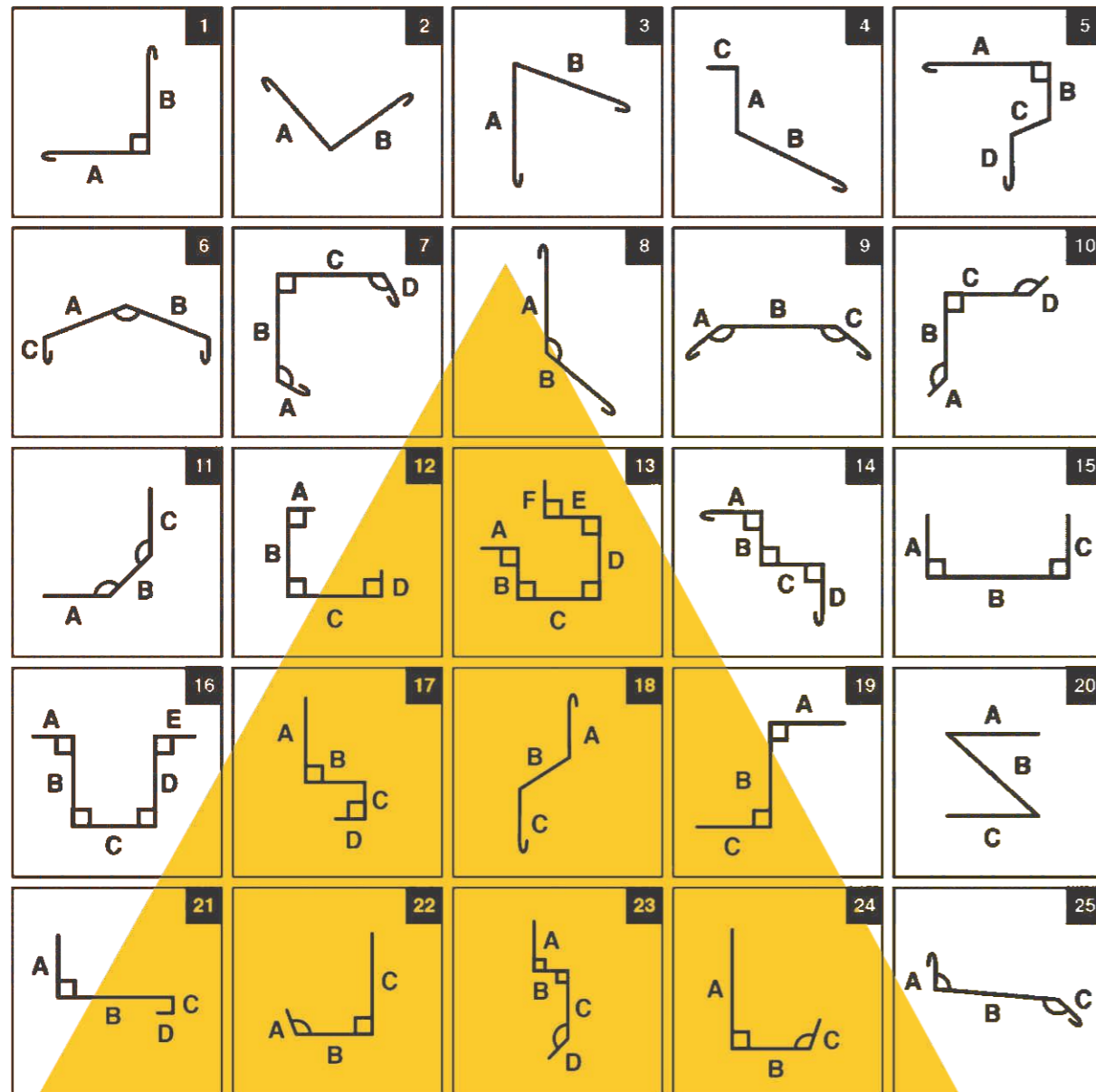

CURVE AND CRIMP ROOFING SHEETS

Crimp Curved Hi Rib is developed to provide versatility and creativity. It brings new and refreshing design to commercial, industrial and domestic buildings.

- Crimp Curved HiRib is available in Galvalume / Galvanized Steel with 245 Mpa, 345 Mpa and 550 Mpa.
- For Crimp Curved Hi Rib, the minimum radius of curvature is 550 mm to inside of sheet And minimum length of the sheet either end of a curve is 180 mm at leading end and 200 mm at the lagging end.
- Arko can manufactured up to 13 mtr single length curve sheet, which we are already supplying for Railways.
- Crimp Curve Profile Ranges - Full length Curve Profile, End Curve Profile, Ridge Curve Profile, North Light Curve Profile.

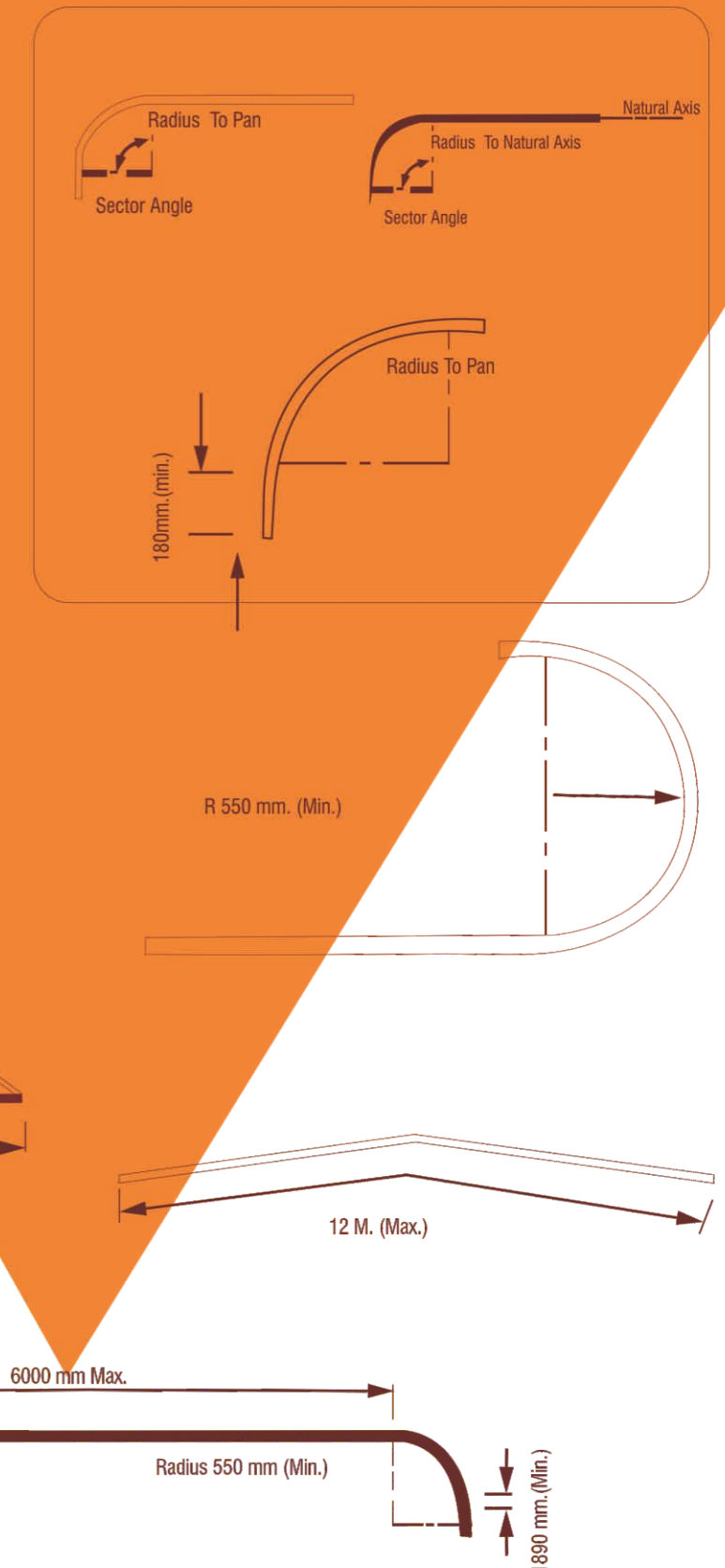

SKILL INDIA DEVELOPMENT, NBCC WITH SAHUSONS INTERIORS - ODISHA



PROJECTS |  arko
TECH

MULTIWALL POLYCARBONATE GIRIDIH JHARKHAND



KO KO TOKE INDIA- ALIGARH U.P

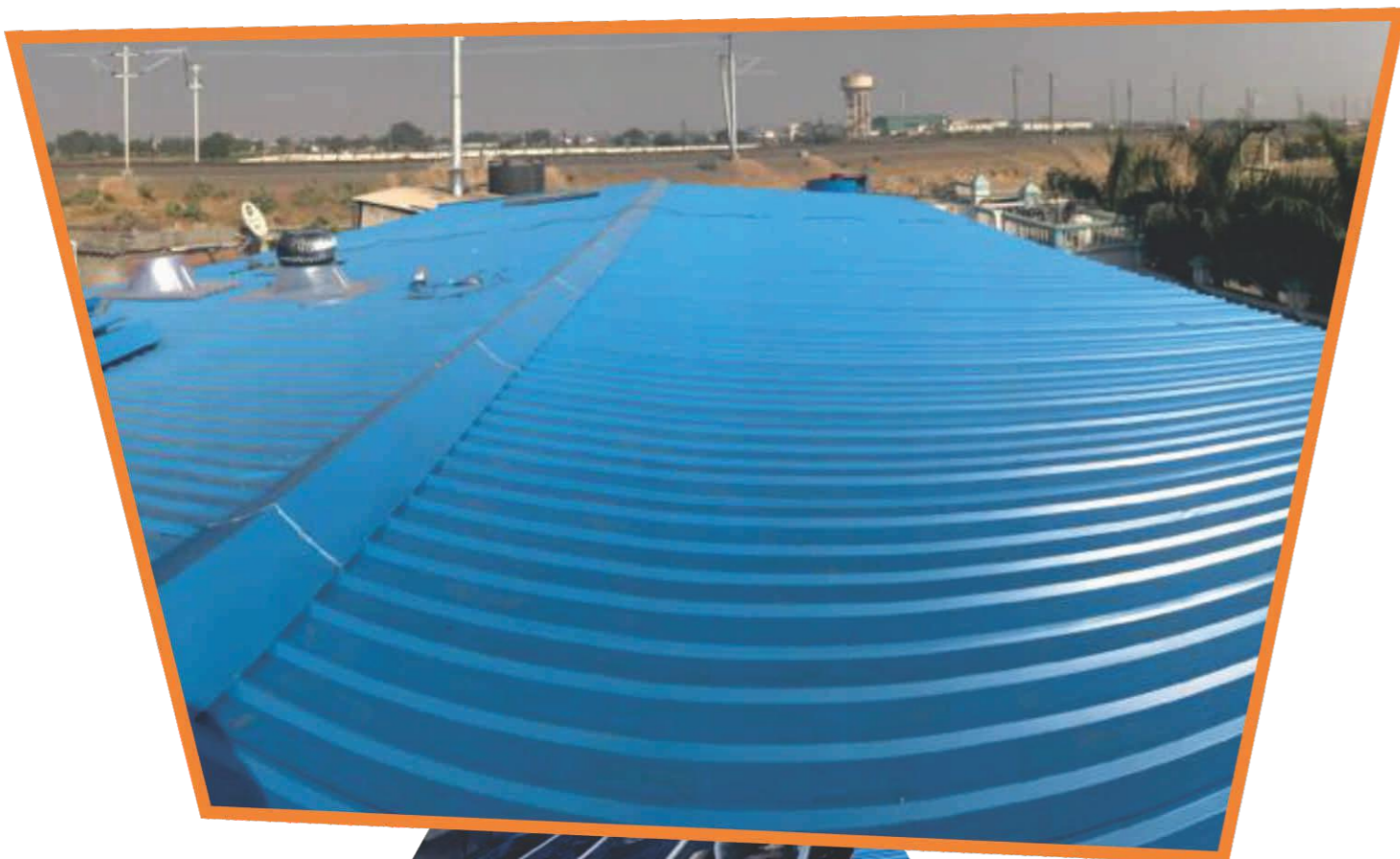

PROJECTS |  arko
TECH

EMAMI LIMITED GUWAHATI, ASSAM



CAVINCARE - GUWAHATI



PROJECTS |  arko
TECH

INDIAN OIL (IOCL)- JAIPUR, RAJASTHAN



ICD-GREATERNOIDA



PROJECTS |  arko
TECH

RAILWAYS ALL UTTAR PRADESH

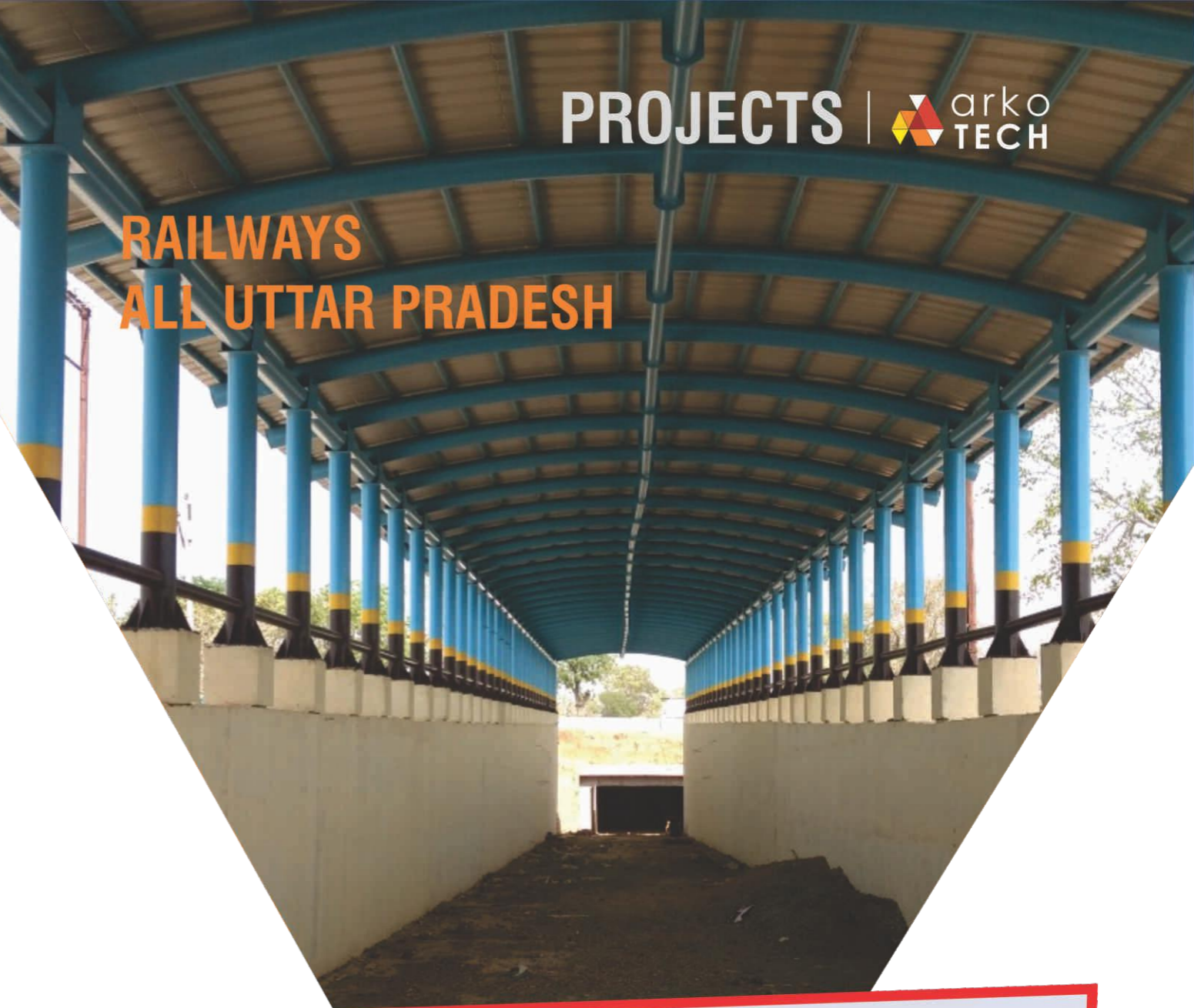

ACCESSORIES

KP SELF DRILLING SCREWS (MADE IN TAIWAN)

1. Self-drilling screw for fast assembly in one step.
2. Perfect Sealing (PS) feature – specially engineered geometry below the head which prevents over-compression of the EPDM washer, helping to reliably seal out water
3. Fastening sheet metal and profiles to steel substructures and framing, with or without intermediate insulation layers
4. EPDM rubber washer – creates a more reliable seal against water.

Sizes in mm - #12-14 & #12-24

Length - 19, 25, 55, 68, 75, 100, 125, 150, 175



Cyclone Washer

For the best performance in a cyclone, it is important to choose the right wind tie and washer system for crest fixing. KP washer is designed to withstand high wind loads and minimise the stress between the washer and the roof sheet.



Silicon Sealant

GP-100, General purpose, cost effective one part acetoxy silicone sealant for many applications • Usage: Suitable for general purpose sealing & bonding applications • Skinning time: 4 – 8 minutes • Curing rate: 1 - 2 hrs/mm • Packing: 260 ml Cartridge (Clear, Black & White)



MP-3010, High quality multi-purpose neutral cure silicone sealant • Usage: Suitable for use in interior & exterior sealing in masonry related applications • Skinning time: 7 – 15 minutes • Curing rate: 2 - 4 hrs/mm • Packing: 280 ml Cartridge (Clear, Black, White, Grey & Metallic)



GUN FOR Silicon Sealant

Gun for 300 ml cartridge, Heavy duty high quality applicator gun for use with cartridge products



OUR CLIENTS

